

12 Furniture and Complementary Accessories Rental

2023

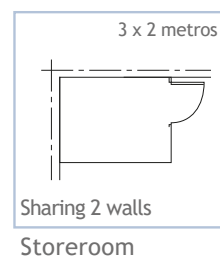

2023

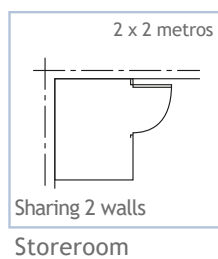
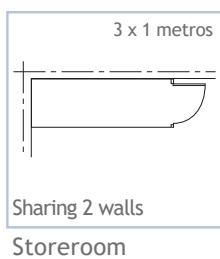
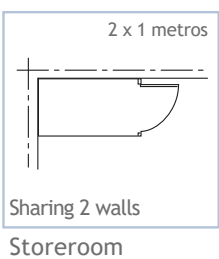
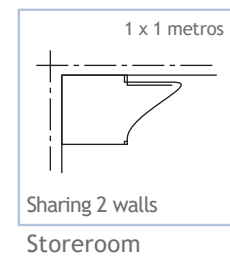
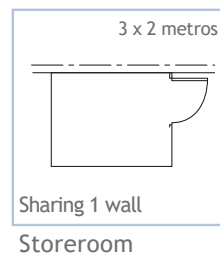
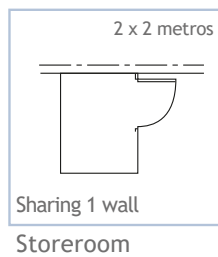
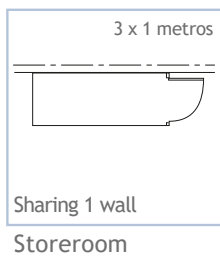
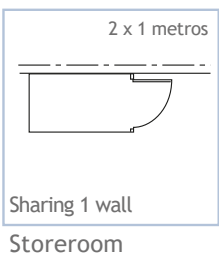
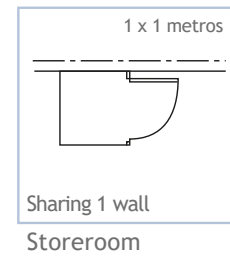
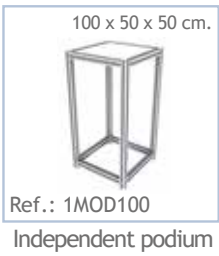
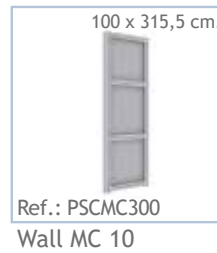

The plan **MUST** be sent. If it is not received, the location of the services will be up to FERIA VALENCIA, with no possibility of further changes during the assembly of the stand.













Furniture and Complementary Accessories Rental 12A

APPLICATION FORM

2023

TRADE FAIR:	
Exhibiting Firm:	
Contact:	Stand Number:
E-mail:	

PACKS

					
Ref.: PACK01	Ref.: PACK02	Ref.: PACK03	Ref.: PACK04	Ref.: PACK05	Ref.: PACK06
					
Ref.: PACK07	Ref.: PACK08	Ref.: PACK09	Ref.: PACK10	Ref.: PACK11	Ref.: PACK12

RATES (VAT not included) RATE 1 (ON TIME) RATE 2 (AFTER DEADLINE)

DESCRIPTION	QUANTITY	RATE 1	RATE 2	TOTAL
<input type="checkbox"/> Ref.: PACK01 4 Director Chairs - Marte Table		86,00	107,50	
<input type="checkbox"/> Ref.: PACK02 4 Confy Chairs - Marte Table		126,00	157,50	
<input type="checkbox"/> Ref.: PACK03 4 Cubiña Chairs - Marte Table		188,00	235,00	
<input type="checkbox"/> Ref.: PACK04 4 Hami Chairs - Marte Table		105,00	131,25	
<input type="checkbox"/> Ref.: PACK05 3 Cubiña Chairs - Marte Office Table - Drawer		170,00	212,50	
<input type="checkbox"/> Ref.: PACK06 3 Eyna Chairs - Marte Office Table - Drawer		222,00	277,50	
<input type="checkbox"/> Ref.: PACK07 Cubic Stool - Counter		121,00	151,25	
<input type="checkbox"/> Ref.: PACK08 Cubic Stool - Showcase Counter		164,00	205,00	
<input type="checkbox"/> Ref.: PACK09 Cubic Stool - MC45 Counter		159,00	198,75	
<input type="checkbox"/> Ref.: PACK10_01 4 Pvc anatomical White Chairs - Marte Office Table		214,00	267,50	
<input type="checkbox"/> Ref.: PACK10_02 4 Pvc anatomical Black Chairs - Marte Office Table		214,00	267,50	
<input type="checkbox"/> Ref.: PACK10_03 4 Pvc anatomical Silver Chairs - Marte Office Table		214,00	267,50	
<input type="checkbox"/> Ref.: PACK11_01 3 Pvc anatomical Chairs - Adjustable Table / White		183,00	228,75	
<input type="checkbox"/> Ref.: PACK11_02 3 Pvc anatomical Chairs - Adjustable Table / Black		183,00	228,75	
<input type="checkbox"/> Ref.: PACK11_03 3 Pvc anatomical Chairs - Adjustable Table / Silver		183,00	228,75	
<input type="checkbox"/> Ref.: PACK12_02 3 Pvc adjustable Stools - Adjustable Table / Black		200,00	250,00	
<input type="checkbox"/> Ref.: PACK12_03 3 Pvc adjustable Stools - Adjustable Table / Silver		200,00	250,00	

DEADLINE FOR SENDING THIS FORM: 4 WORKING DAYS BEFORE SET-UP. ANY APPLICATION RECEIVED WITH LESS THAN 4 WORKING DAYS BEFORE THE START OF SET UP, WILL IMPLY (RATE 2) AVAILABILITY OF ALL REFERENCES IS NOT GUARANTEED.

PLEASE SEND THIS FORM BY E-MAIL: servicecenter@feriavalencia.com

Date, signature, and company stamp

Date: Valencia, / / 202....

Furniture and Complementary Accessories Rental 12B

APPLICATION FORM

2023

TRADE FAIR:

Exhibiting Firm:

Contact:

Stand Number:

E-mail:

CHAIRS / STOOLS

RATES (VAT not included)

RATE 1 (ON TIME)

RATE 2 (AFTER DEADLINE)

DESCRIPTION	QUANTITY	RATE 1	RATE 2	TOTAL
<input type="checkbox"/> Ref.: 1SIL Director Chair / Black metallic - Linen		12,00	15,00	
<input type="checkbox"/> Ref.: 7SIL Confy Chair / Metallic - Blue textile		19,00	23,75	
<input type="checkbox"/> Ref.: 9SIL Cubiña-N Chair / Natural wood		39,00	48,75	
<input type="checkbox"/> Ref.: 10SIL Cubiña-T Chair / Stained wood		39,00	48,75	
<input type="checkbox"/> Ref.: 12SIL Eyna Chair / Light gray polypropylene		51,00	63,75	
<input type="checkbox"/> Ref.: 19SIL Hami Chair / Gray metal folding chair		16,00	20,00	
<input type="checkbox"/> Ref.: 20SIL01 Pvc anatomical Chair/ White		48,00	60,00	
<input type="checkbox"/> Ref.: 20SIL02 Pvc anatomical Chair / Black		48,00	60,00	
<input type="checkbox"/> Ref.: 20SIL03 Pvc anatomical Chair/ Silver		48,00	60,00	
<input type="checkbox"/> Ref.: 21SIL Fibre frame Chair/ White - Metallic legs		62,00	77,50	
<input type="checkbox"/> Ref.: 24SIL Linus Chair / White - Pvc		26,00	32,50	
<input type="checkbox"/> Ref.: 25SIL Vulcano Chair		26,00	32,50	
<input type="checkbox"/> Ref.: 26SIL Office Chair with wheels		60,00	75,00	
<input type="checkbox"/> Ref.: 9TAB Cubic Walnut Stool / Metallic		43,00	53,75	
<input type="checkbox"/> Ref.: 10TAB Cubic Beech Stool / Metallic		43,00	53,75	
<input type="checkbox"/> Ref.: 11TAB02 Pvc adjustable Stool / Black		55,00	68,75	
<input type="checkbox"/> Ref.: 11TAB03 Pvc adjustable Stool / Silver		55,00	68,75	
<input type="checkbox"/> Ref.: 15TAB Marte Stool / Wenge wood seat-Chrome		43,00	53,75	

DEADLINE FOR SENDING THIS FORM: 4 WORKING DAYS BEFORE SET-UP. ANY APPLICATION RECEIVED WITH LESS THAN 4 WORKING DAYS BEFORE THE START OF SET UP, WILL IMPLY (RATE 2) AVAILABILITY OF ALL REFERENCES IS NOT GUARANTEED.

PLEASE SEND THIS FORM BY E-MAIL: servicecenter@feriavalencia.com

Date, signature, and company stamp

Date: Valencia, / / 202....



FERIA VALENCIA

Furniture and Complementary Accessories Rental **12C**

APPLICATION FORM

2023

TRADE FAIR:

Exhibiting Firm:

Contact:

Stand Number:

E-mail:

TABLES

RATES (VAT not included) RATE 1 (ON TIME) RATE 2 (AFTER DEADLINE)

DESCRIPTION	QUANTITY	RATE 1	RATE 2	TOTAL
<input type="checkbox"/> Ref.: 4MES Marte melamine Table / Round table		37,00	46,25	
<input type="checkbox"/> Ref.: 20MES Marte chromed Table / Glass top acid		54,00	67,50	
<input type="checkbox"/> Ref.: 22MES Marte office Table / Rectangular glass top		57,00	71,25	
<input type="checkbox"/> Ref.: 27MES Marte low Table / Round glass top acid		37,00	46,25	
<input type="checkbox"/> Ref.: 28MES Marte high Table / Round glass top acid		59,00	73,75	
<input type="checkbox"/> Ref.: 30MES Marte square Table / Square glass top		41,00	51,25	
<input type="checkbox"/> Ref.: 24MES Cubic Beech Table / Hight colour Titan		53,00	66,25	
<input type="checkbox"/> Ref.: 26MES02 Pvc Table, adjustable height / Black		69,00	86,25	
<input type="checkbox"/> Ref.: 26MES03 Pvc Table, adjustable height / Silver		69,00	86,25	
<input type="checkbox"/> Ref.: 31MES Office Table / Melamine Top		42,00	52,50	
<input type="checkbox"/> Ref.: 5ARM Aluminum Wardrobe / Beech 1 shelves		41,00	51,25	
<input type="checkbox"/> Ref.: 6ARM Aluminum Wardrobe / Beech 2 shelves		53,00	66,25	
<input type="checkbox"/> Ref.: 3CAJ Melamine Drawer Aluminum - Beech		28,00	35,00	

PODIUMS / COUNTERS

RATES (VAT not included) RATE 1 (ON TIME) RATE 2 (AFTER DEADLINE)

DESCRIPTION	QUANTITY	RATE 1	RATE 2	TOTAL
<input type="checkbox"/> Ref.: 1MOD100 Independent podium with top		43,00	53,75	
<input type="checkbox"/> Ref.: 2MOD075 Independent podium with top		38,00	47,50	
<input type="checkbox"/> Ref.: 3MOD050 Independent podium with top		32,00	40,00	
<input type="checkbox"/> Ref.: 4MOD025 Independent podium with top		25,00	31,25	
<input type="checkbox"/> Ref.: 6MOD200 Bookshelf 2 metres / 4 Shelves		100,00	125,00	
<input type="checkbox"/> Ref.: 1MOSTRAD Straight Aluminum Counter-Melamine		92,00	115,00	
<input type="checkbox"/> Ref.: 2MOSTRAD Showcase Counter		129,00	161,25	
<input type="checkbox"/> Ref.: MOSMC45 Counter in MC-45		139,00	173,75	

DEADLINE FOR SENDING THIS FORM: 4 WORKING DAYS BEFORE SET-UP. ANY APPLICATION RECEIVED WITH LESS THAN 4 WORKING DAYS BEFORE THE START OF SET UP, WILL IMPLY (RATE 2) AVAILABILITY OF ALL REFERENCES IS NOT GUARANTEED.
PLEASE SEND THIS FORM BY E-MAIL: servicecenter@feriavalencia.com

Date, signature, and company stamp

Date: Valencia, / / 202....

Furniture and Complementary Accessories Rental **12D**

APPLICATION FORM

2023

TRADE FAIR:	
Exhibiting Firm:	
Contact:	Stand Number:
E-mail:	

SOFAS / COUCHES / PUFFS

RATES (VAT not included) RATE 1 (ON TIME) RATE 2 (AFTER DEADLINE)

DESCRIPTION	QUANTITY	RATE 1	RATE 2	TOTAL
<input type="checkbox"/> Ref.: 2SOFA01 Sofa 2 seats and chromed arms/Cream		235,00	293,75	
<input type="checkbox"/> Ref.: 2SOFA02 Sofa 2 seats and chromed arms/Black		235,00	293,75	
<input type="checkbox"/> Ref.: 2SOFA03 Sofa 2 seats and chromed arms/Red		235,00	293,75	
<input type="checkbox"/> Ref.: 3SON Bubble Couch / 1 Seat white polyurethane		96,00	120,00	
<input type="checkbox"/> Ref.: 4SON01 Couch 1 seat and chromed arms/Cream		178,00	222,50	
<input type="checkbox"/> Ref.: 4SON02 Couch 1 seat and chromed arms/Black		178,00	222,50	
<input type="checkbox"/> Ref.: 4SON03 Couch 1 seat and chromed arms/Red		178,00	222,50	
<input type="checkbox"/> Ref.: 1PUFF01 Cream Puff 50x55 cms.		80,00	100,00	
<input type="checkbox"/> Ref.: 1PUFF02 Black Puff 50x55 cms.		80,00	100,00	

ACCESSORIES

RATES (VAT not included) RATE 1 (ON TIME) RATE 2 (AFTER DEADLINE)

DESCRIPTION	QUANTITY	RATE 1	RATE 2	TOTAL
<input type="checkbox"/> Ref.: LID005 PVC Canvas S/Digital printing		34,50	43,125	
<input type="checkbox"/> Ref.: LMP003 Microperforated Canvas digital printing		34,50	43,125	
<input type="checkbox"/> Ref.: LOGOD100 vinyl in digital printing (on melamine panel per sqm)		41,00	51,25	
<input type="checkbox"/> Ref.: LOGOV100 vinyl in digital printing (on chipboard panel per sqm)		47,00	58,75	
<input type="checkbox"/> Ref.: 5PER Medias Lunas Clothes stand		41,00	51,25	
<input type="checkbox"/> Ref.: 1PAP Plastic wastepaper basket		12,00	15,00	
<input type="checkbox"/> Ref.: LOGO UP TO 1 linear metre of vinyl		57,00	71,25	

DEADLINE FOR SENDING THIS FORM: 4 WORKING DAYS BEFORE SET-UP. ANY APPLICATION RECEIVED WITH LESS THAN 4 WORKING DAYS BEFORE THE START OF SET UP, WILL IMPLY (RATE 2) AVAILABILITY OF ALL REFERENCES IS NOT GUARANTEED.
PLEASE SEND THIS FORM BY E-MAIL: servicecenter@feriavalencia.com

Date, signature, and company stamp

Date: Valencia, / / 202....

Furniture and Complementary Accessories Rental **12E**

APPLICATION FORM

2023

TRADE FAIR:	
Exhibiting Firm:	
Contact:	Stand Number:
E-mail:	

STOREROOMS

RATES (VAT not included) RATE 1 (ON TIME) RATE 2 (AFTER DEADLINE)

DESCRIPTION	QUANTITY	RATE 1	RATE 2	TOTAL
CHIBOARD STOREROOM				
<input type="checkbox"/> Ref.: ALMA1M01 Painted chipboard Storeroom/Sharing 1 wall 1x1		356,00	445,00	
<input type="checkbox"/> Ref.: ALMA1M02 Painted chipboard Storeroom/Sharing 1 wall 2x1		456,00	570,00	
<input type="checkbox"/> Ref.: ALMA1M03 Painted chipboard Storeroom/Sharing 1 wall 3x1		555,00	693,75	
<input type="checkbox"/> Ref.: ALMA1M04 Painted chipboard Storeroom/Sharing 1 wall 2x2		655,00	818,75	
<input type="checkbox"/> Ref.: ALMA1M05 Painted chipboard Storeroom/Sharing 1 wall 3x2		854,00	1.067,50	
<input type="checkbox"/> Ref.: ALMA2M01 Painted chipboard Storeroom/Sharing 2 walls 1x1		257,00	321,25	
<input type="checkbox"/> Ref.: ALMA2M02 Painted chipboard Storeroom/Sharing 2 walls 2x1		346,00	432,50	
<input type="checkbox"/> Ref.: ALMA2M03 Painted chipboard Storeroom/Sharing 2 walls 3x1		456,00	570,00	
<input type="checkbox"/> Ref.: ALMA2M04 Painted chipboard Storeroom/Sharing 2 walls 2x2		465,00	581,25	
<input type="checkbox"/> Ref.: ALMA2M05 Painted chipboard Storeroom/Sharing 2 walls 3x2		555,00	693,75	
STOREROOM MC10 - OCT				
<input type="checkbox"/> Ref.: ALMC1M01 MC-10 Storeroom Sharing 1 wall 1x1		159,00	198,75	
<input type="checkbox"/> Ref.: ALMC1M02 MC-10 Storeroom Sharing 1 wall 2x1		207,00	258,75	
<input type="checkbox"/> Ref.: ALMC1M03 MC-10 Storeroom Sharing 1 wall 3x1		255,00	318,75	
<input type="checkbox"/> Ref.: ALMC1M04 MC-10 Storeroom Sharing 1 wall 2x2		303,00	318,75	
<input type="checkbox"/> Ref.: ALMC1M05 MC-10 Storeroom Sharing 1 wall 3x2		352,00	440,00	
<input type="checkbox"/> Ref.: ALMC2M01 MC-10 Storeroom Sharing 2 walls 1x1		111,00	138,75	
<input type="checkbox"/> Ref.: ALMC2M02 MC-10 Storeroom Sharing 2 walls 2x1		159,00	198,75	
<input type="checkbox"/> Ref.: ALMC2M03 MC-10 Storeroom Sharing 2 walls 3x1		207,00	258,75	
<input type="checkbox"/> Ref.: ALMC2M04 MC-10 Storeroom Sharing 2 walls 2x2		207,00	258,75	
<input type="checkbox"/> Ref.: ALMC2M05 MC-10 Storeroom Sharing 2 walls 3x2		255,00	318,75	
<input type="checkbox"/> Ref.: ALOC1M01 OCT Storeroom Sharing 1 wall 1x1		137,00	171,25	
<input type="checkbox"/> Ref.: ALOC1M02 OCT Storeroom Sharing 1 wall 2x1		174,00	217,50	
<input type="checkbox"/> Ref.: ALOC1M03 OCT Storeroom Sharing 1 wall 3x1		211,00	263,75	
<input type="checkbox"/> Ref.: ALOC1M04 OCT Storeroom Sharing 1 wall 2x2		248,00	310,00	
<input type="checkbox"/> Ref.: ALOC1M05 OCT Storeroom Sharing 1 wall 3x2		285,00	356,25	
<input type="checkbox"/> Ref.: ALOC2M01 OCT Storeroom Sharing 2 walls 1x1		99,00	123,75	
<input type="checkbox"/> Ref.: ALOC2M02 OCT Storeroom Sharing 2 walls 2x1		137,00	171,25	
<input type="checkbox"/> Ref.: ALOC2M03 OCT Storeroom Sharing 2 walls 3x1		174,00	217,50	
<input type="checkbox"/> Ref.: ALOC2M04 OCT Storeroom Sharing 2 walls 2x2		174,00	217,50	
<input type="checkbox"/> Ref.: ALOC2M05 OCT Storeroom Sharing 2 walls 3x2		211,00	263,75	

DEADLINE FOR SENDING THIS FORM: 4 WORKING DAYS BEFORE SET-UP. ANY APPLICATION RECEIVED WITH LESS THAN 4 WORKING DAYS BEFORE THE START OF SET UP, WILL IMPLY (RATE 2) AVAILABILITY OF ALL REFERENCES IS NOT GUARANTEED.
PLEASE SEND THIS FORM BY E-MAIL: servicecenter@feriavalencia.com

Date, signature, and company stamp

Furniture and Complementary Accessories Rental **12F**

APPLICATION FORM

2023

TRADE FAIR:

Exhibiting Firm:

Contact:

Stand Number:

E-mail:

ACCESSORIES RENTAL

RATES (VAT not included)

RATE 1 (ON TIME)

RATE 2 (AFTER DEADLINE)

DESCRIPTION	QUANTITY	RATE 1	RATE 2	TOTAL
<input type="checkbox"/> Ref.: 2ESTANTE Horizontal Shelf Modular System		21,00	26,25	
<input type="checkbox"/> Ref.: 1ESTANTE Inclined Shelf Modular System		21,00	26,25	
<input type="checkbox"/> Ref.: ESTA001 Horizontal Shelf Agglomerated		38,00	47,50	
<input type="checkbox"/> Ref.: ESTA004 Horizontal Shelf Melamime		40,00	50,00	
<input type="checkbox"/> Ref.: ESTA005 Inclined Shelf Melamine		40,00	50,00	
<input type="checkbox"/> Ref.: PASEP300 Wall OCT Systeml		39,00	48,75	
<input type="checkbox"/> Ref.: 2PUERTAS Door OCT System		71,00	88,75	
<input type="checkbox"/> Ref.: PSCMC300 Wall MC 10		50,00	62,50	
<input type="checkbox"/> Ref.: PSCMC200 Wall MC 10		53,00	66,25	
<input type="checkbox"/> Ref.: 7PUERTAS Wall MC 10		64,00	80,00	
<input type="checkbox"/> Ref.: 4VITRINA Showcase with glass and light		202,00	252,50	
<input type="checkbox"/> Ref.: 7VITRINA Showcase with glass and light		170,00	212,50	
<input type="checkbox"/> Ref.: 5VITRINA Showcase with glass and light		148,00	185,00	

The plan MUST be sent. If it is not received, the location of the services will be up to FERIA VALENCIA, with no possibility of further changes during the assembly of the stand.

**DEADLINE FOR SENDING THIS FORM: 4 WORKING DAYS BEFORE SET-UP. ANY APPLICATION RECEIVED WITH LESS THAN 4 WORKING DAYS BEFORE THE START OF SET UP, WILL IMPLY (RATE 2) AVAILABILITY OF ALL REFERENCES IS NOT GUARANTEED.
PLEASE SEND THIS FORM BY E-MAIL: servicecenter@feriavalencia.com**

Date, signature, and company stamp

Date: Valencia, / / 202....

